

# LW9 Sliding Door Lock



ASSA ABLOY

## Installation Instructions

Experience a safer and more open world

**Application:** Provides safe latching or secure deadlocking for sliding aluminium and timber doors.  
**Operation:** Snib to latch, key to deadlock.

### Tools Required:

- Drill
- $\emptyset 3\text{mm}$  Drill Bit
- Phillips Screwdriver #2
- Hacksaw or cutters
- $\emptyset 10\text{mm}$  Drill Bit
- Rule and pencil or marker

### LW9 Components

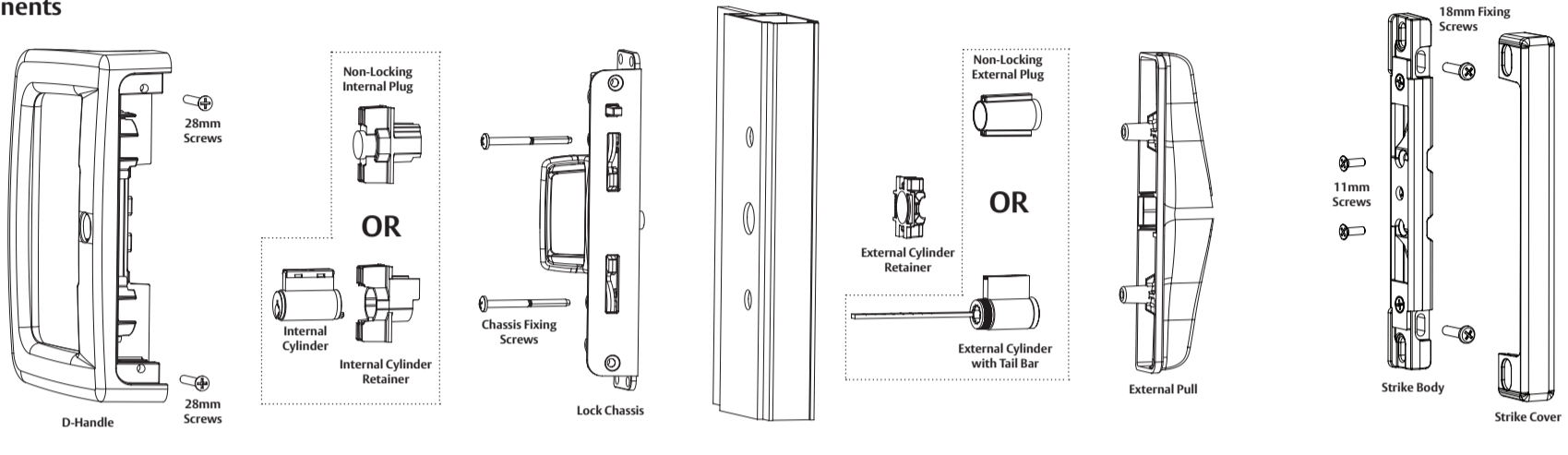

### 1. Door Preparation

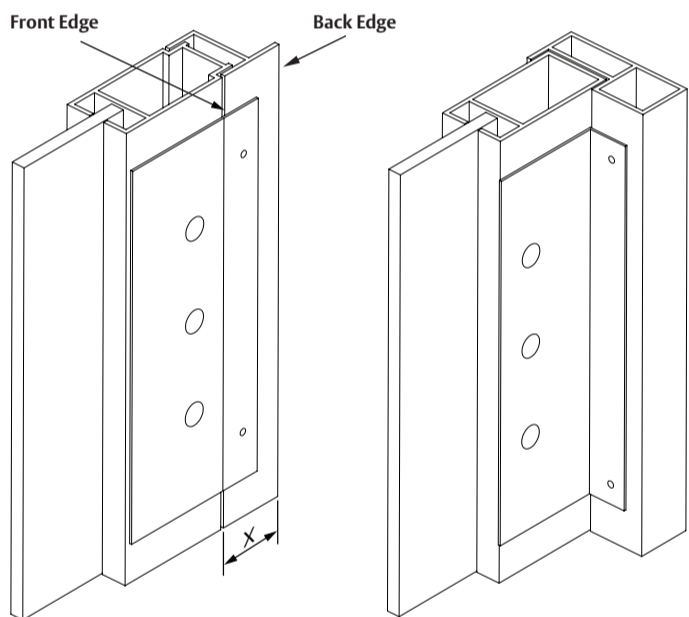

#### Surface Fix (Follow holes labelled A)

- Ensure door is closed correctly. Place template on the inside surface of the jamb (fixed door frame) at the desired height.
  - If 'X' is greater than 19mm, align 'LINE 1' with the front edge.
  - If 'X' is less than 19mm align 'LINE 2' against the back edge.
  - Mark and drill handle fixing holes labelled 'A' (3 x  $\emptyset 10\text{mm}$ ).
  - Mark and drill strike fixing holes labelled 'A' (2 x  $\emptyset 3\text{mm}$ ).
- Note: Do not fold template over front edge step.

#### Side Fix (Follow holes labelled B)

- Fold template 90° along 'LINE 1'.
- Ensure door is closed correctly. Place template against the door surface at the desired height.
- Mark and drill handle fixing holes labelled 'B' (3 x  $\emptyset 10\text{mm}$ ).
- Mark and drill strike fixing holes labelled 'B' (2 x  $\emptyset 3\text{mm}$ ).

### 2. Lock Chassis Preparation

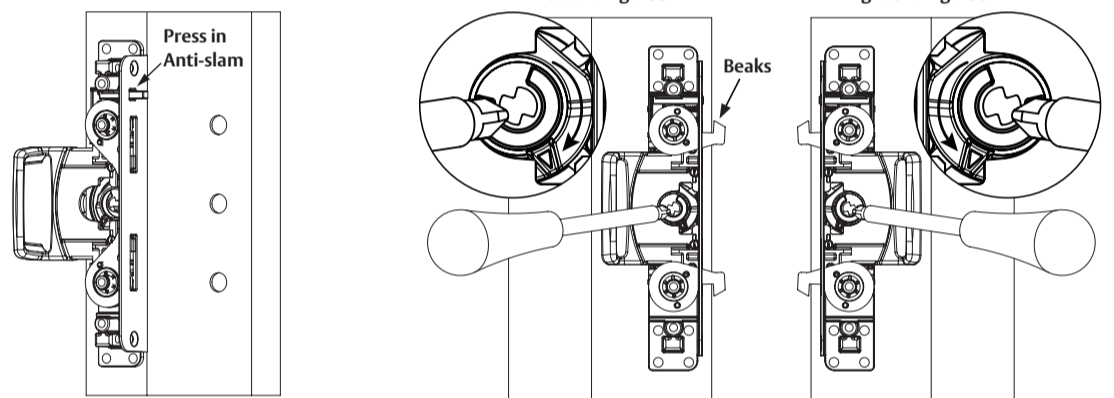

- Orientate the lock chassis so that the lock beaks face towards the door jamb.
- To set the lock for right or left sliding door configuration, use a screw driver to rotate the Hub downward, to the corresponding position as shown.

### 3. External Pull Preparation

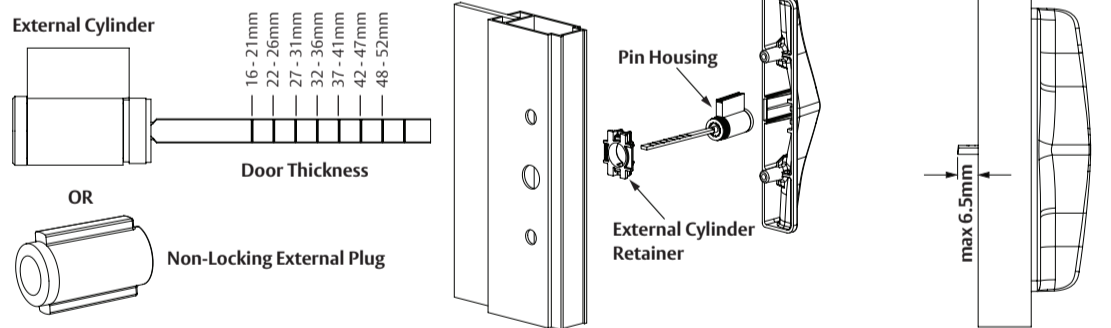

- For a non-locking external pull, use the external plug and retainer supplied
- For a locking external pull, trim the tail bar of the cylinder at the mark corresponding to the door thickness as shown using Hacksaw or cutter
- Fit the plug with the cylinder with trimmed tail bar and orientate so that the pin housing points up with respect to the door.
- Push fit the cylinder retainer into the back of the pull.
- Check the tail bar length by placing the pull on the external door face. The tail bar should pass through the centre hole, protruding no more than 6.5mm from the inside face of the door.

### 4. Screw Selection

- Several chassis fixing screws are provided to suit different door thicknesses.
- Use the table to identify which are the correct length fixing screws for your application.

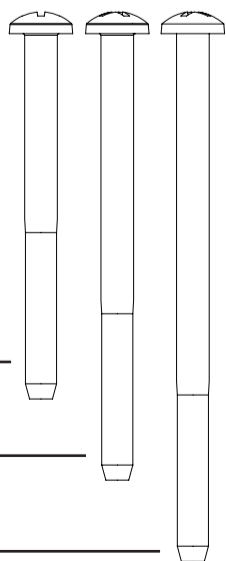

Door Thickness	Screw Selection
19 - 28 mm	M4 x 45mm
29 - 38 mm	M4 x 55mm
39 - 45 mm	M4 x 65mm

Template

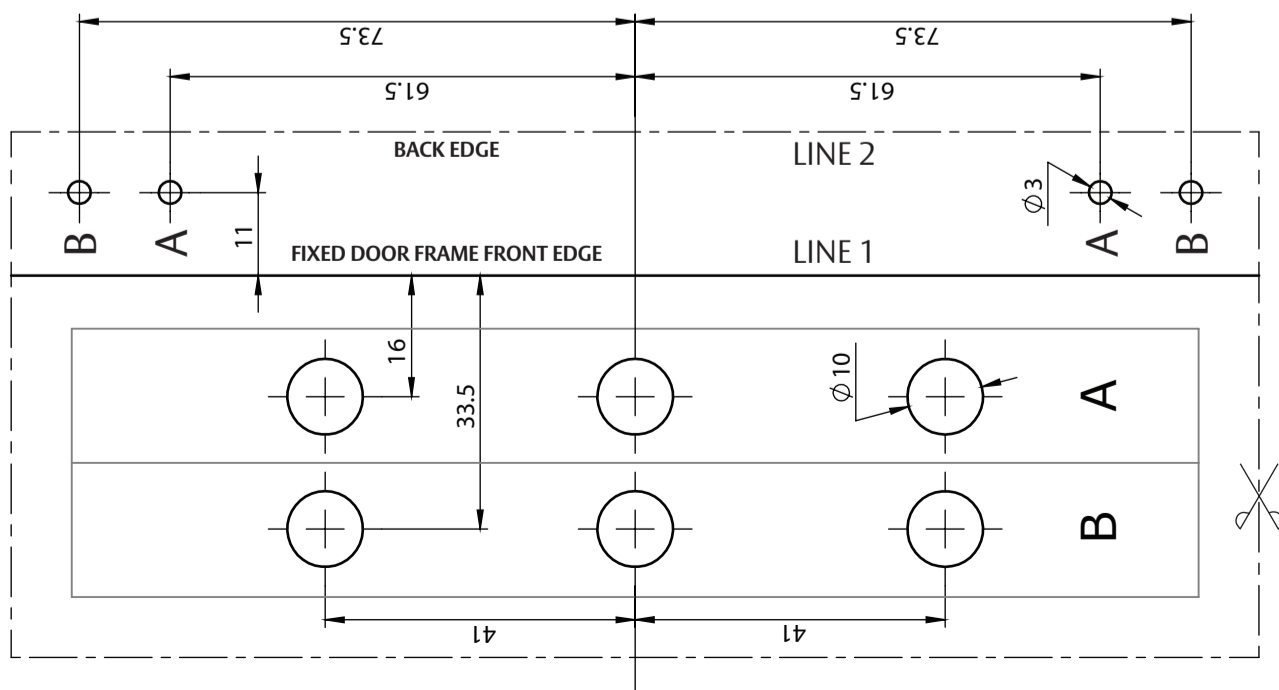

# LW9 Sliding Door Lock



ASSA ABLOY

## Installation Instructions

Experience a safer and more open world

### 5. Fixing Chassis & Pull To Door

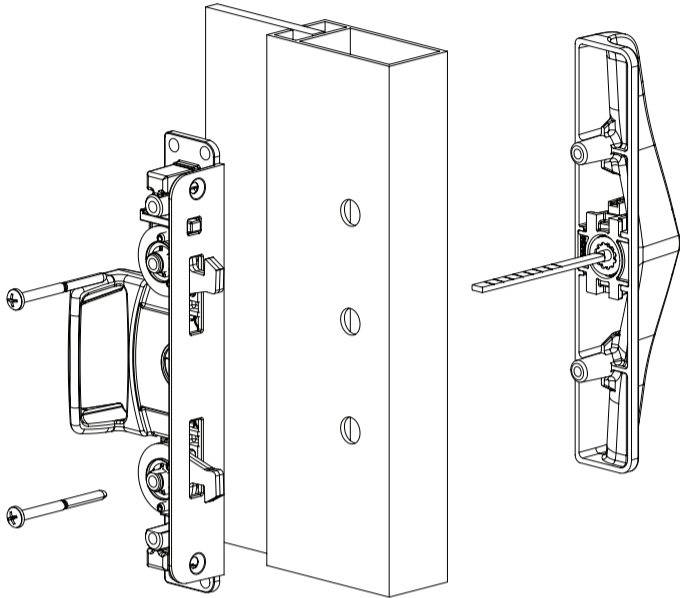

- Place the external pull on the external face of the door.
- Place the chassis on the internal face of the door.
- For exterior locking versions, align the tailbar into the lock chassis hub.
- Secure together with chassis fixing screws provided.

### 6. Fixing Internal D-Handle

- For locking version, fit the cylinder into the internal cylinder retainer.
- For non-locking, fit the internal non-locking plug orientated as shown below.

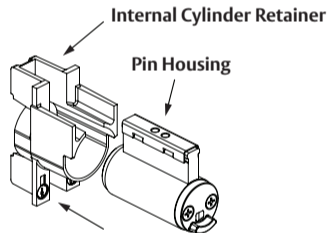

- For locking version, orientate the cylinder so that the pin housing points up with respect to the door.
- For non-locking version orientate the plug with the arrow point upwards with respect to the door. Firmly push the plug into the D-handle.

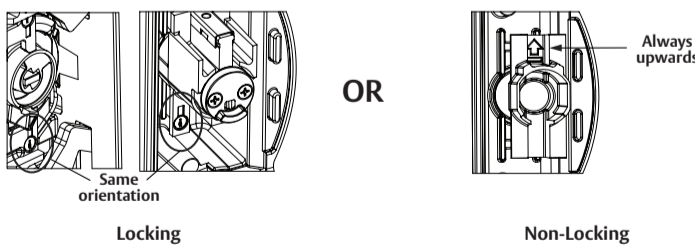
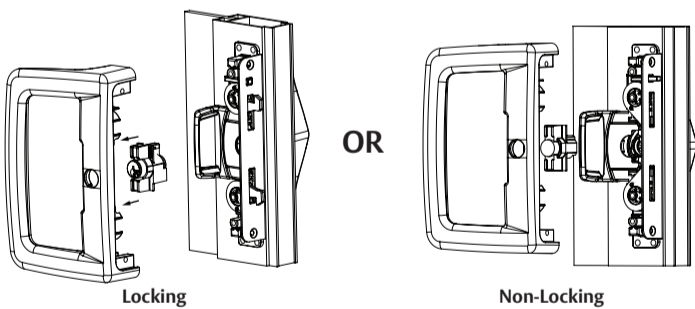

- Fix the D-handle to the lock chassis by screwing the 2x28mm screws into the side.



### 7. Strike Installation

#### Surface Fix

- Fix the strike body to the jamb with the 2x18mm screws. Do not tighten.
- Close the door and adjust the strike up or down until it is central to the handle, then tighten fixing screws.
- Fit the strike cover and secure with the 2 x 11mm screws.

#### Side Fix

- Fit the strike cover and secure with the two M4x11mm screws.
- Fix the strike to the jamb with the 2x18mm screws. Do not tighten.
- Close the door and adjust the strike up or down until it is central to the handle, then open the door and tighten fixing screws.

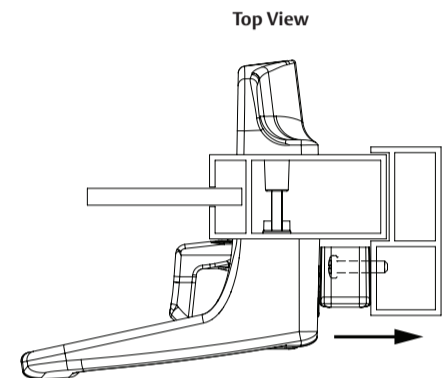
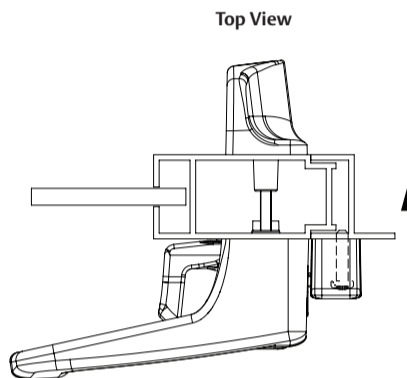

Note: Arrows indicate direction of strike fixing screws

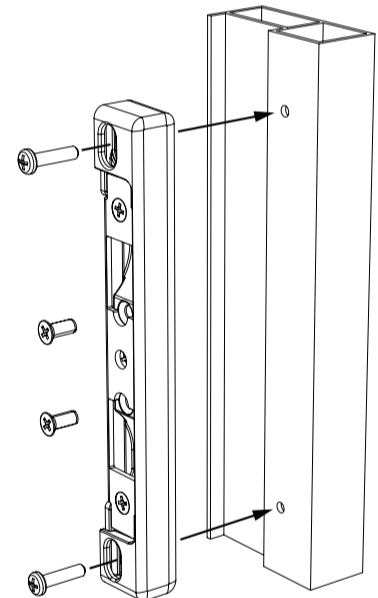
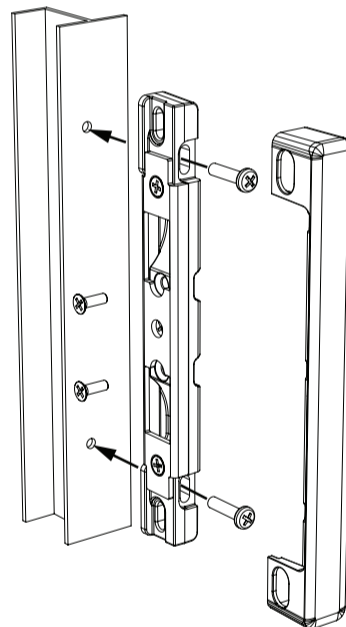

### 8. Check Lock Operation

- Depress the anti-slam pin to check the operation of the lock using both the snib and key-to-lock functions.
- Close the door and ensure that the beaks engage properly with the strike.
- If further adjustment is necessary, partially unscrew the strike plate fixing screws. Adjust the jacking screw height as required and re-tighten the strike plate fixing screws.

Note: Maximum adjustment is 4mm. Do not exceed this as it may compromise security.

