

Designed to suit the Blum LEGRABOX system, the information below applies to both Layout 1 and Layout 2. Please note these are recommendations only, configurations are fully customisable.

Nominal Drawer length recommended: 450mm (424mm available internal depth, below diagrams use 417mm)

Minimum cabinet size recommended: 893mm (820mm + 41mm + 32mm = 893mm)

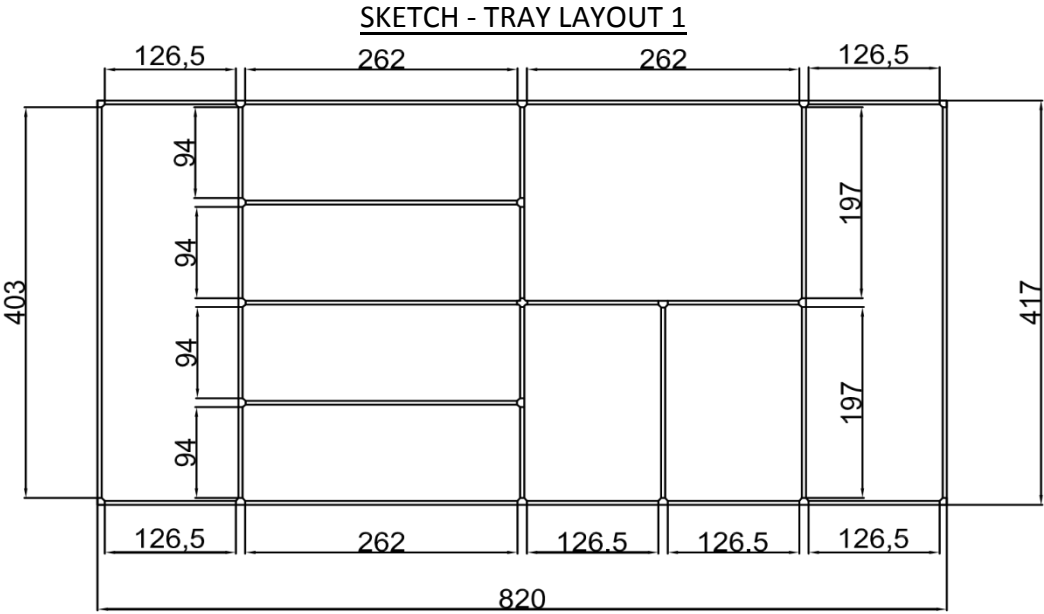

**Dividers :** 126.5 mm x 8, 262 mm x 6, 94 mm x 8, 197 mm x 3, 403 mm x 2

**Connectors:** Two Side x 4, Three Side x 14, Four Side x 1

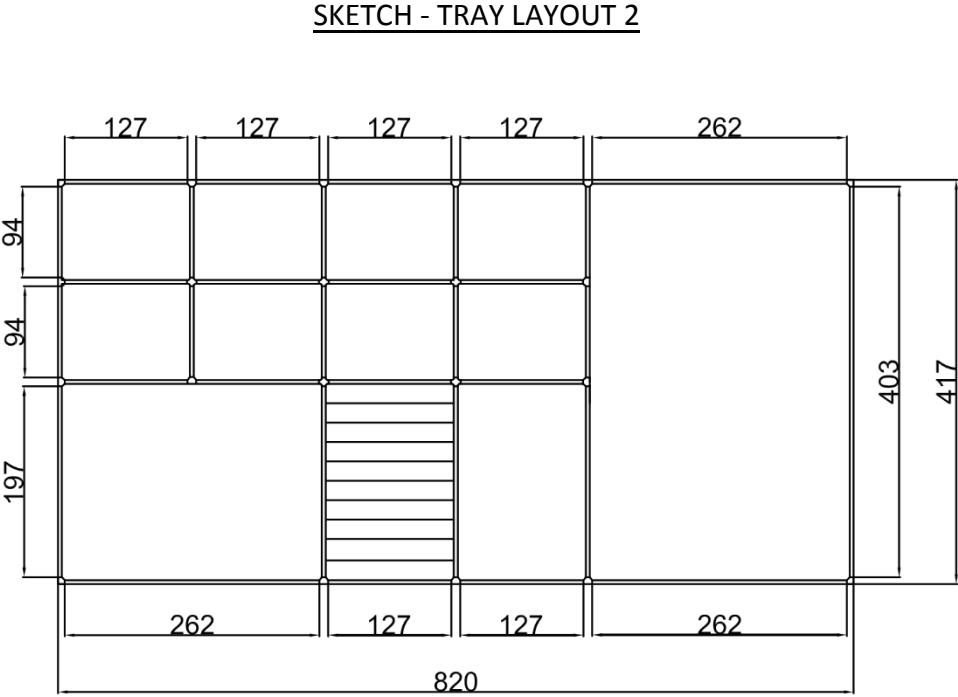

**Dividers:** 127 mm x 14, 262 mm x 3, 94 mm x 10, 197 mm x 4, 403 mm x 1

**Connectors:** Two Side x 4, Three Side x 12, Four Side x 5

Designed to suit the Blum LEGRABOX system, the information below applies to both Layout 3 and Layout 4.  
Please note these are recommendations only, configurations are fully customisable.

Nominal Drawer length recommended: 500mm (474mm available internal depth, below diagrams use 457mm)

Minimum cabinet size recommended: 1042mm (969mm + 41mm + 32mm = 1042mm)

### SKETCH - TRAY LAYOUT 3

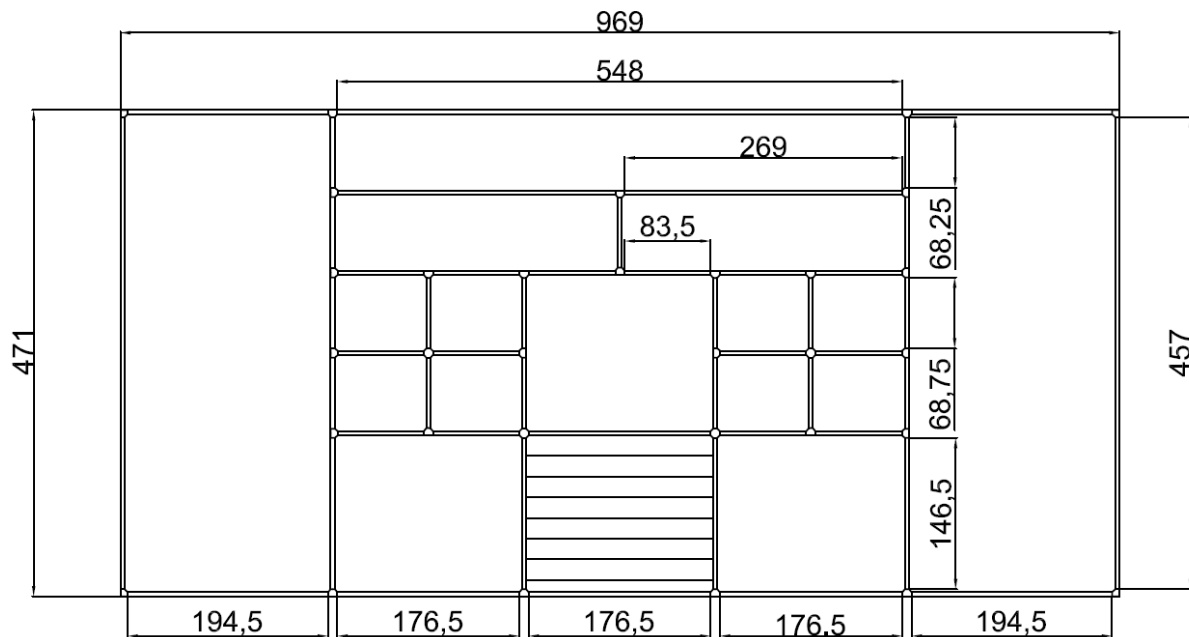

#### Materials Required:

Dividers: 194.5 mm x 6, 269 mm x 2, 548 mm x 1, 83.5 mm x 14,  
176.5 mm x 3, 146.5 mm x 4, 68.5 mm x 17, 457 mm x 2

Connectors: Two Side x 4, Three Side x 22, Four Side x 6

### SKETCH - TRAY LAYOUT 4

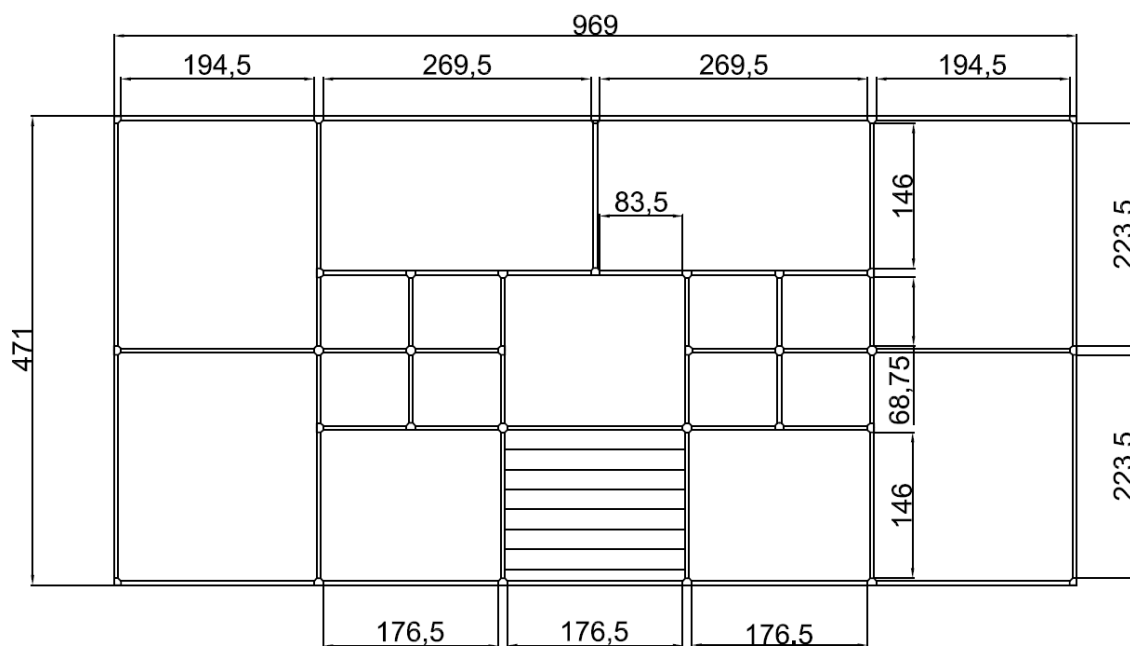

#### Materials Required:

Dividers: 194.5 mm x 6, 269.5 mm x 2, 223.5 mm x 4, 146 mm x 7, 176.5 mm x 4,  
83.5 mm x 14, 68.5 mm x 12

Connectors: Two Side x 4, Three Side x 22, Four Side x 6

Designed to suit the Blum LEGRABOX system, the information below applies to both Layout 5 and Layout 6.  
Please note these are recommendations only, configurations are fully customisable.

Nominal Drawer length recommended: 500mm (474mm available internal depth, below diagrams use 468mm)

Minimum cabinet size recommended: 601mm (528mm + 41mm + 32mm = 601mm)

SKETCH - TRAY LAYOUT 5

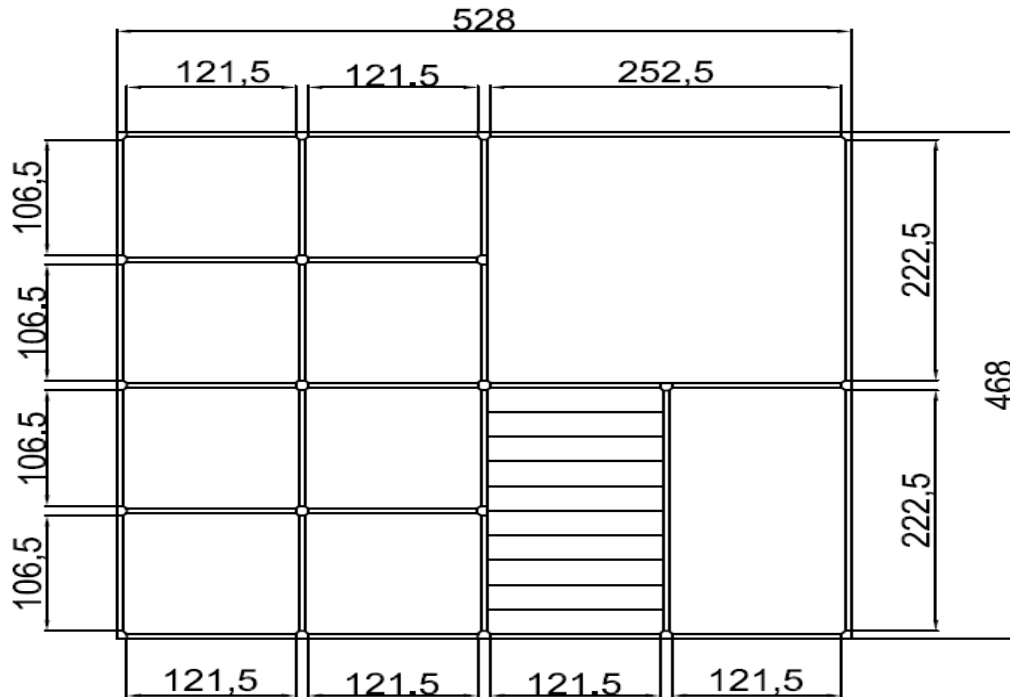

**Dividers: 121.5 mm x 14, 252.5 mm x 1, 106.5 mm x 12, 222.5 mm x 3**

**Connectors: Two Side x 4, Three Side x 12, Four Side x 4**

Designed to suit the Blum LEGRABOX system, the information below applies to both Layout 5 and Layout 6.  
Please note these are recommendations only, configurations are fully customisable.

Nominal Drawer length recommended: 500mm (474mm available internal depth, below diagrams use 468mm)

Minimum cabinet size recommended: 601mm (528mm + 41mm + 32mm = 601mm)

SKETCH - TRAY LAYOUT 6

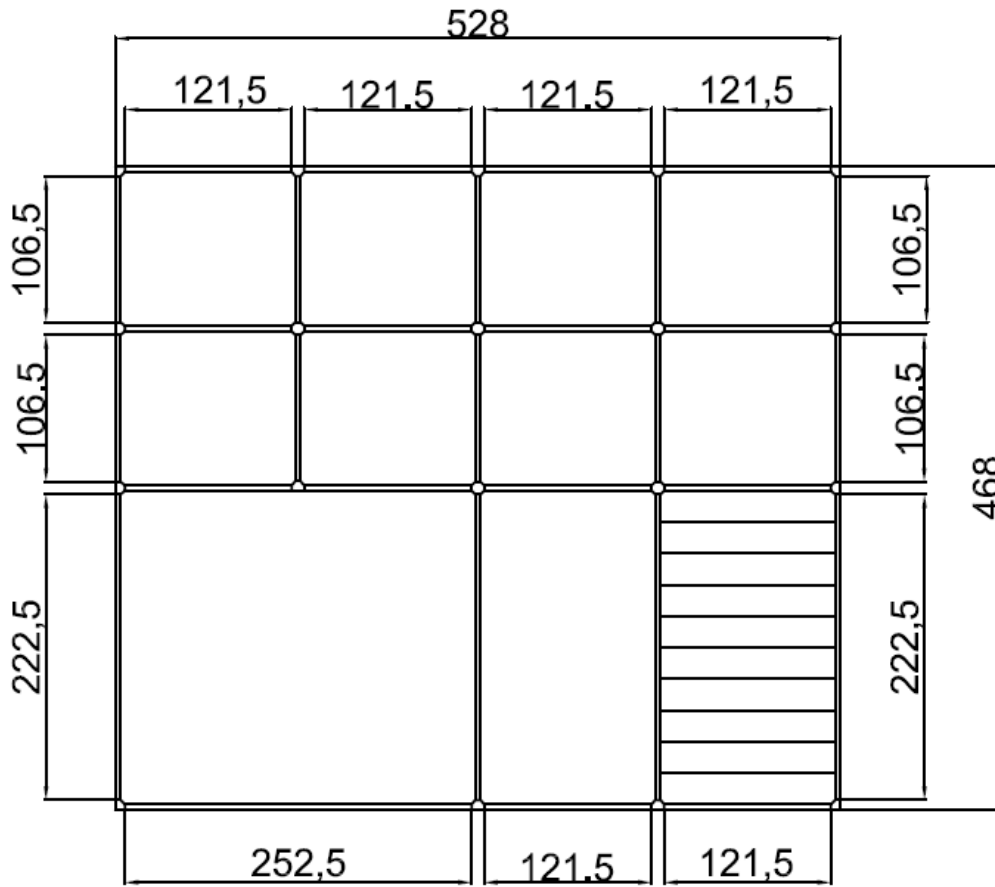

**Materials Required:**

**Dividers:** 121.5mm x 14, 252.5 mm x 1, 106.5 mm x 10, 222.5 mm x 4

**Connectors:** Two Side x 4, Three Side x 10, Four Side x 5

Designed to suit the Blum LEGRABOX system, the information below applies to Layout 7. Please note these are recommendations only, configurations are fully customisable.

Nominal Drawer length recommended: 450mm (424mm available internal depth, below diagrams use 418mm)

Minimum cabinet size recommended: 501mm (428mm + 41mm + 32mm = 501mm)

SKETCH - TRAY LAYOUT 7

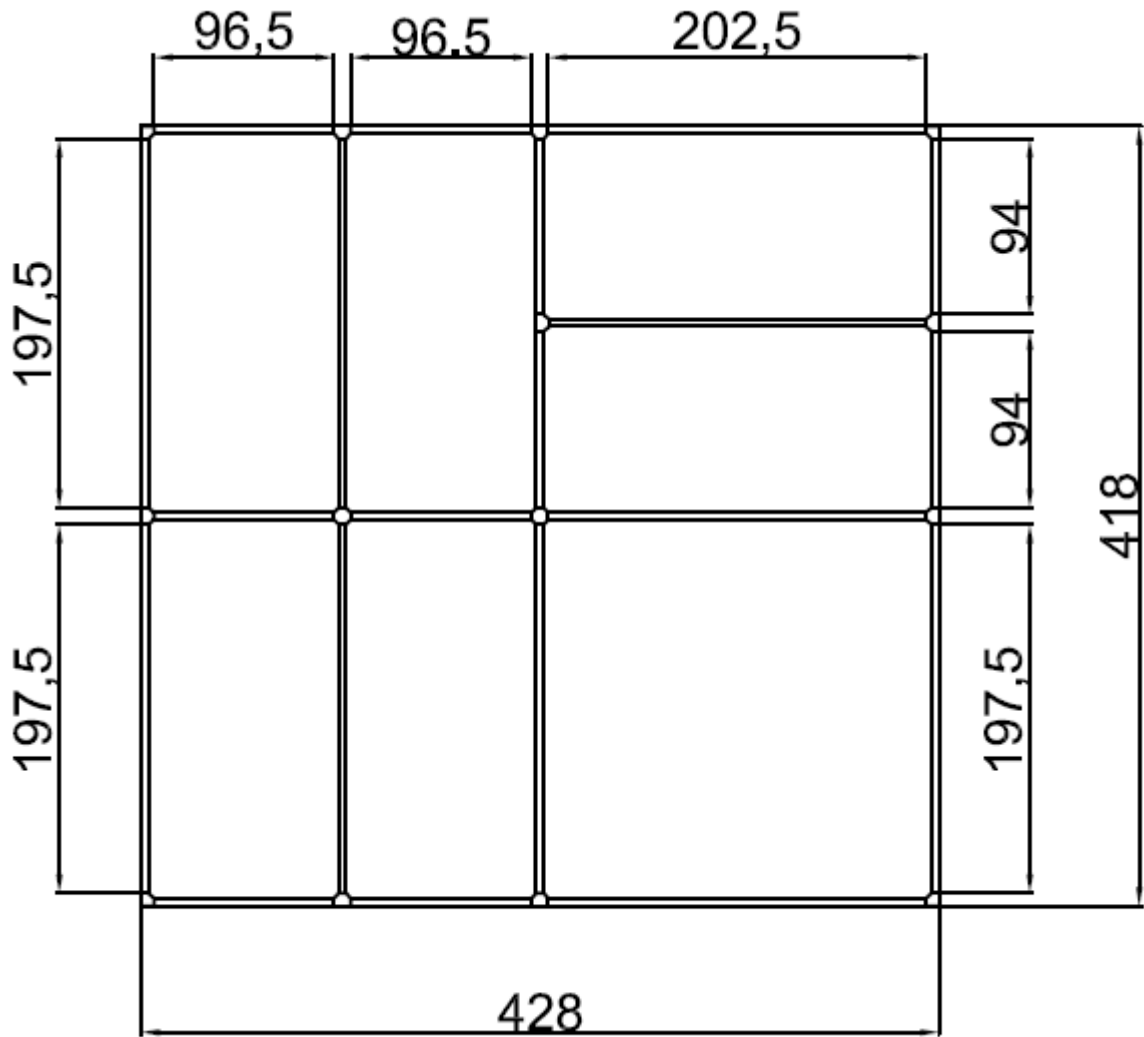

**Materials Required;**

**Dividers: 96.5 mm x 6, 202.5 mm x 4, 197.5 mm x 6, 94 mm x 4**

**Connectors: Two Side x 4, Three Side x 8, Four Side x 2**